



1/2" = 1' HORIZONTAL SCALE  
 1" = 1' VERTICAL SCALE



THIRTEENTH STREET

STODDARD AVENUE

AVENUE

BASE LINE STREET

STODDARD AVENUE

Old grade 1022.0  
 Old grade 1031.7  
 Old grade 1028.0  
 Old grade 1028.0

**Abbreviations:**  
 The mark (L) signifies four feet.  
 The mark (U) signifies eight feet.  
 The mark (S) signifies six feet.  
 No. means number.  
 & means center line of street.

Green lines in profile show surface grade of center of street.  
 Black lines in profile show grade of center of street.  
 Blue lines in plan show property lines.  
 Red lines in profile show grade of sewer line of proposed sewer.  
 Yellow lines in plan show sewer line of proposed sewer.  
 A 'y' in plan and 'y' in profile signify a vertical pipe sewer.  
 A 'w' in plan and 'w' in profile signify a water pipe sewer.

**Notes:**  
 Note nos. of manholes and vaults that shall with surface proposed.

**Quantities:**  
 @ - 6 by 6 wyes  
 2025 linear feet of a vitrified pipe sewer, including wyes & risers.  
 1 1/2 inch tank.

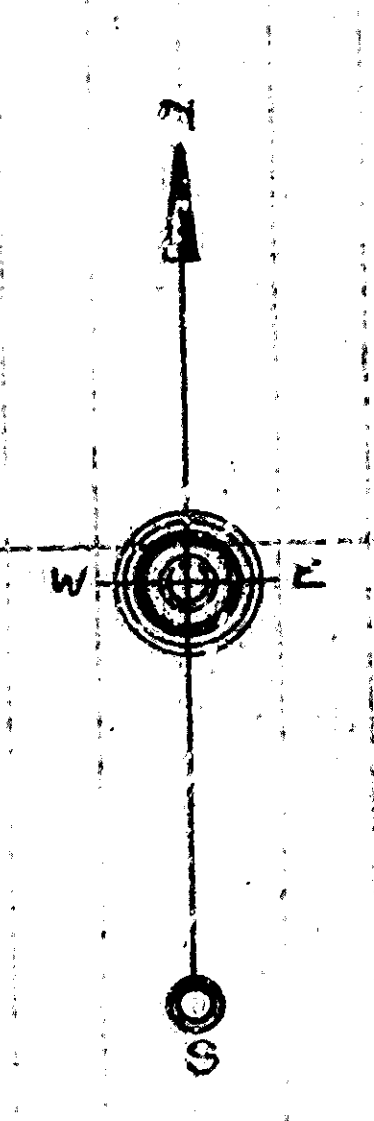

1/2" = 1' HORIZONTAL SCALE  
 1" = 1' VERTICAL SCALE

1/2" = 1' HORIZONTAL SCALE  
 1" = 1' VERTICAL SCALE

PLAN AND PROFILE  
 SHOWING  
 6" VITRIFIED PIPE SEWER  
 TO BE CONSTRUCTED IN  
 STODDARD AVENUE  
 BETWEEN THIRTEENTH STREET AND THIRTEENTH STREET

Scale: 1/2" = 1' HORIZONTAL SCALE  
 1" = 1' VERTICAL SCALE  
 October 21, 1917

MINIATURE COPY OF ORIGINAL  
 DRAWING MADE BY ENGINEER

SCALE 1/2" = 1' HORIZONTAL SCALE  
 1" = 1' VERTICAL SCALE